

Brookfield Residential

Welcome to the Evia.



Floor Plan Details

2,012 sq. ft. | 3 bedrooms | 2.5 baths | 2-car garage



Additional Options:

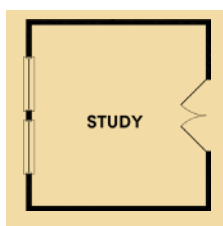

Study

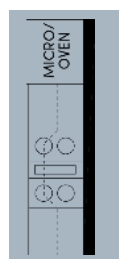

Kitchen

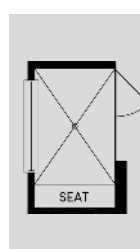

Shower Seat



Modern Farmhouse



Hill Country



Traditional



BrookfieldTX.com | 512-928-4877

The total number, layout, design and location of homes; unit mix; and the location, design and layout of recreational facilities may be changed due to a number of circumstances, including governmental requirements and market demand. Dimensions are approximate in nature and are not intended for final reference. Brookfield Residential and its affiliates reserve the right to change homesites, floor plans and home prices and make modifications in materials and specifications at any time without prior notice. © 2023 Brookfield Residential Properties ULC. All rights reserved. REV. MARCH 2023